

# EVENTS SPACE OVERVIEW

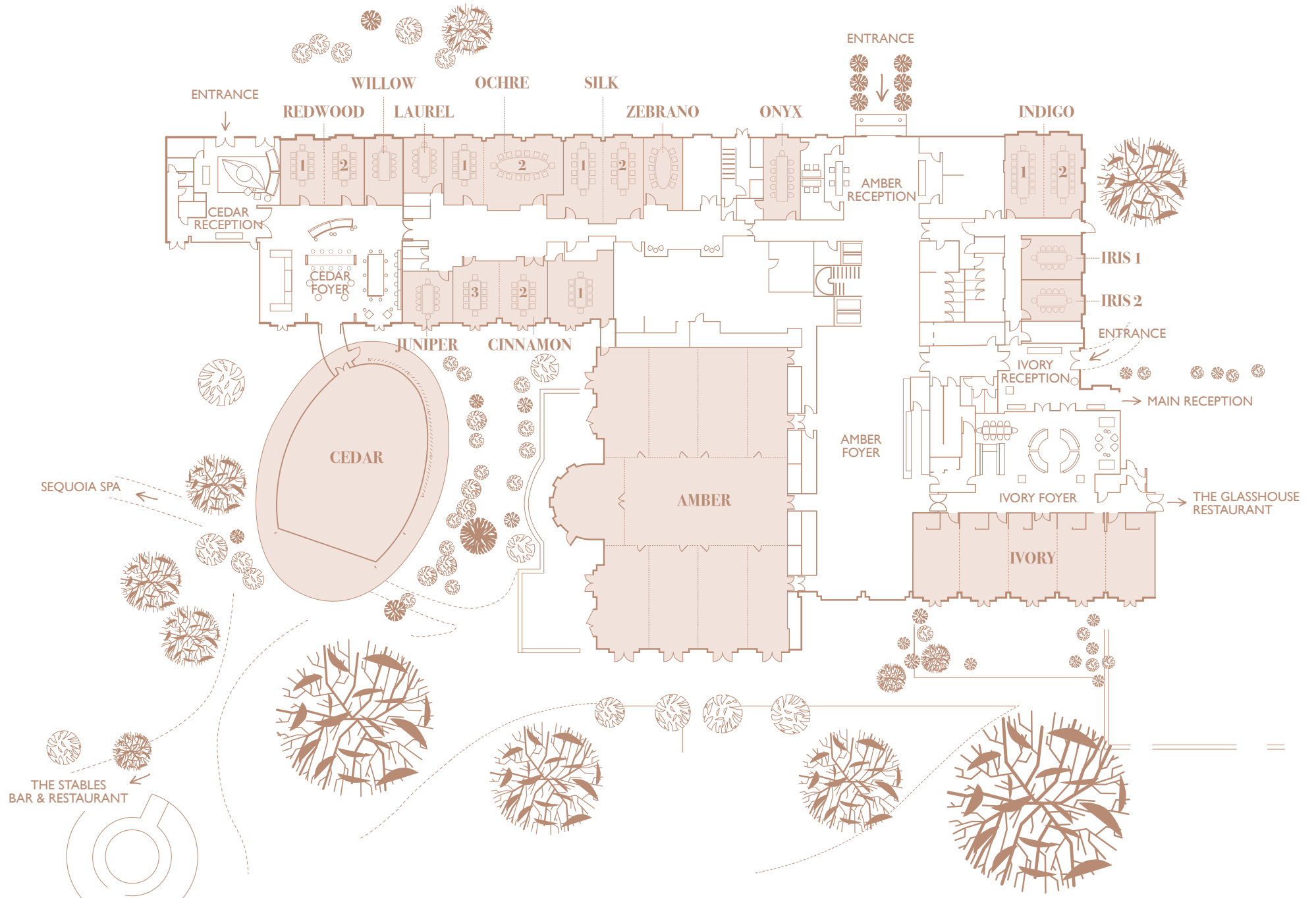

# AMBER



*Our largest most extensive space is a flexible, stylish choice for conferences, presentations, board meetings, team building workshops, special events and celebrations. Amber has its own private entrance, extensive breakout and social space and wrap around natural daylight.*

## KEY FEATURES

- Purpose Built
- Natural daylight
- Ground floor
- Private entrance
- Divisible into nine rooms
- Adjoining reception area
- Vehicular access area
- Two Drop down screens  
(One in Amber 6 and one in Amber 2)
- Linked to The Cinnamon
- Linked Room Control
- In-built PA system
- Bespoke chandelier
- 2 x 3 phase 63amp separate feed (Amber 1)
- 1 x 3 phase 63amp separate feed (Amber 5)
- WiFi
- In-built projector Amber 2/3,4 & 6/7
- Pin Spotting
- Adjoining outdoor terrace
- Air conditioning

## DIMENSIONS

- Area: 521.5sqm
- Height: 3.9m to 4.7m
- Length: 29.56m
- Width: 17.63m

## SET-UPS

- Theatre: 450\*
- Classroom: 300\*
- Boardroom: 78
- U-shape: 78
- Cabaret: 256
- Reception: 700
- Lunch/Dinner: 480
- Dinner dance: 420
- Seated buffet: 330
- Standing buffet: 500
- Exhibition: 36 stands of 3x2m

\*front projection

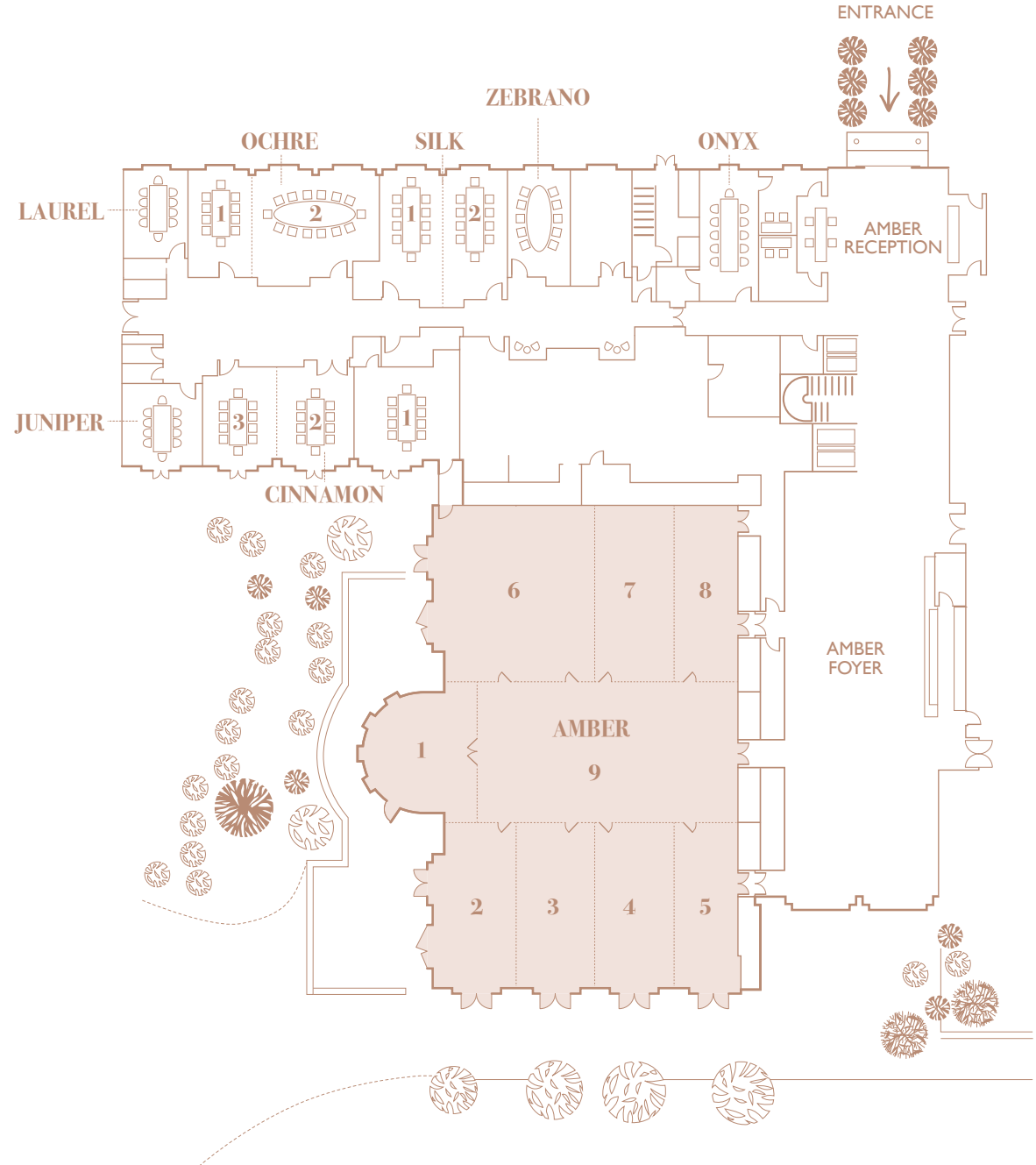

# CINNAMON



*One of our largest syndicate rooms with its own garden terrace and linked to The Amber Suite, The Cinnamon Suite can host up to 100 delegates.*

*The decor is cool and contemporary. Natural daylight, integrated technology, air conditioning and on-hand assistance come as standard.*

## KEY FEATURES

- Purpose built
- LED screen technology
- WiFi
- Natural daylight
- Light reduction
- Ground floor
- Divisible into 3 rooms
- Air conditioning
- In-built projector
- Tungsten Halogen lights
- In-room dimmer controls

## DIMENSIONS

- Area: 92.34sqm
- Height: 2.9m to 3.4m
- Length: 17.1m
- Width: 5.4m

## SET-UPS

- Theatre: 100\*
- Classroom: 42\*
- Boardroom: 40
- U-shape: 35
- Cabaret: 48\*
- Reception: 120
- Lunch/Dinner: 70
- Dinner dance: 50
- Seated buffet: 50
- Standing buffet: 100
- Exhibition: 6 stands of 3x2m

\*front projection

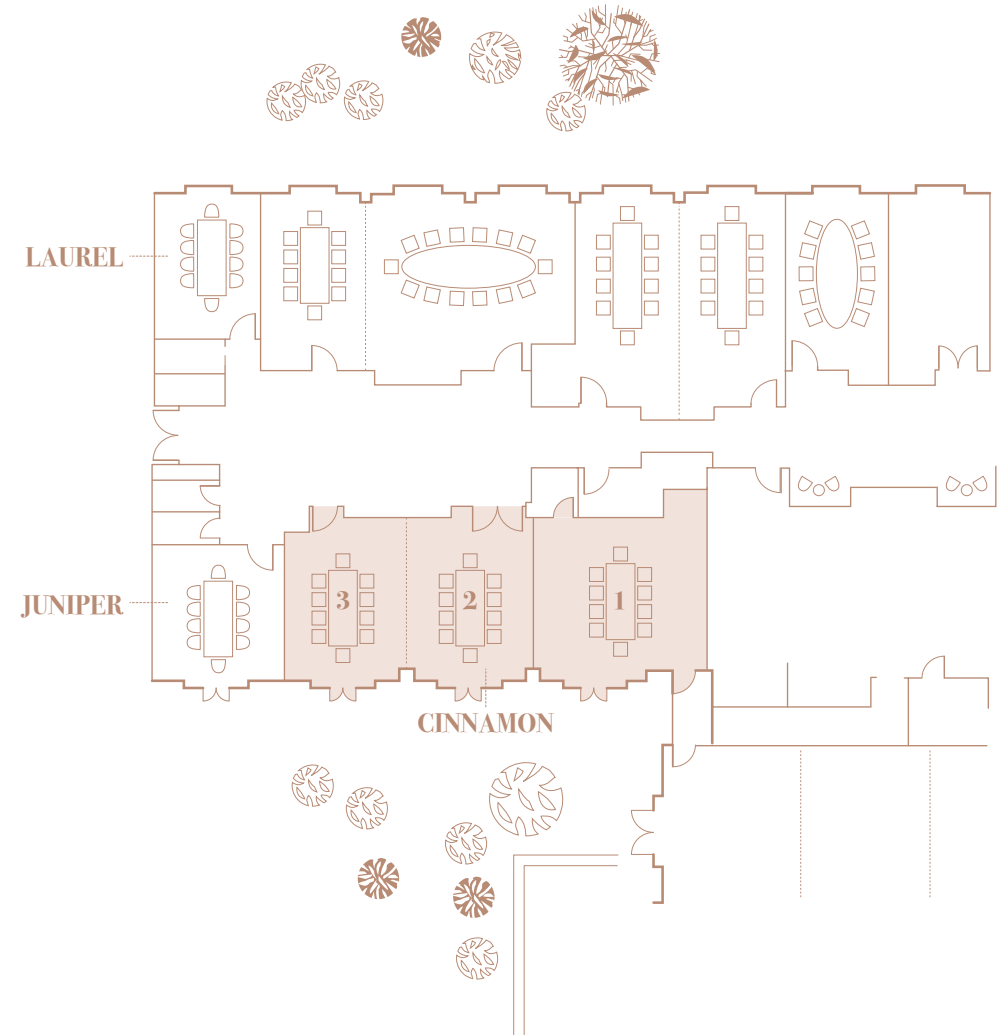

# LAUREL & JUNIPER



*Two centrally located breakout spaces with lots of natural daylight and a contemporary design. With in-built LED's, these rooms are ideal for small breakout sessions.*

## KEY FEATURES

- Purpose built
- LED screen technology
- WIFI
- Natural daylight
- Ground floor
- Juniper has its own garden terrace
- Wall hanging flip charts

## LAUREL DIMENSIONS

- Area: 19.63sqm
- Height: 2.9m
- Length: 5.41m
- Width: 3.63m

## SET-UPS

- Theatre: 12
- Boardroom: 10

## JUNIPER DIMENSIONS

- Area: 21.7sqm
- Height: 2.9mm
- Length: 4.91m
- Width: 4.42m

## SET-UPS

- Theatre: 12
- Boardroom: 10

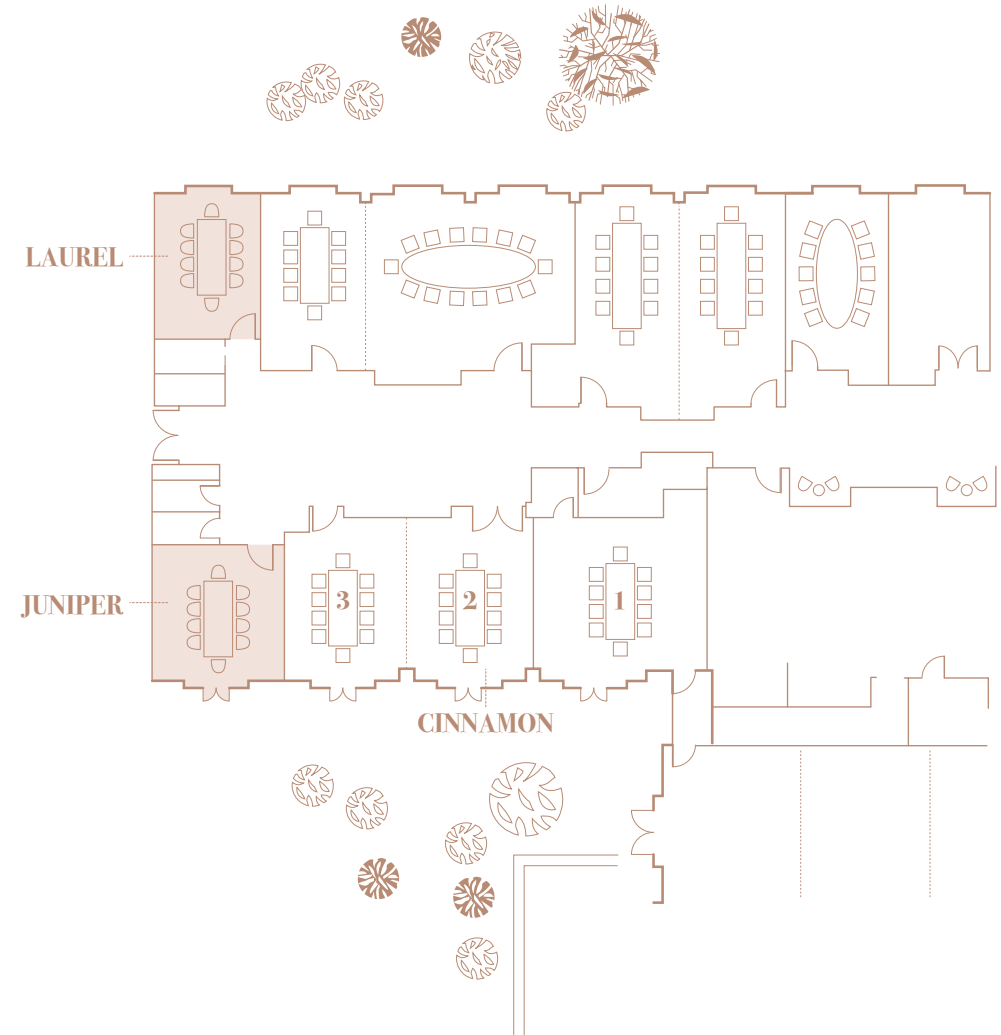

# SILK & OCHRE



*Ideal for smaller conferences, presentations, board meetings, or private dining and celebrations. Both the Silk and Ochre rooms can be divided into two separate spaces, offering you greater flexibility and use of space. Located in the West Wing; natural daylight and complimentary WiFi comes as standard.*

## KEY FEATURES

- Purpose built
- LED screen technology
- WiFi
- Natural daylight
- Light reduction
- Ground floor
- Divisible into 2 rooms
- Air conditioning
- Tungsten Halogen lights
- In-room dimmer controls

## SILK

### DIMENSIONS

- Area: 42sqm
- Height: 2.9 to 3.4m
- Length: 5.6m
- Width: 7.5m

### SET-UPS

- Theatre: 42
- Classroom: 20
- Boardroom: 16
- U-shape: 12
- Cabaret: 20
- Reception: 56
- Lunch/Dinner: 30
- Seated buffet: 20
- Standing buffet: 30

## OCHRE

### DIMENSIONS

- Area: 54.72sqm
- Height: 2.9 to 3.4mm
- Length: 4.8m
- Width: 11.4m

### SET-UPS

- Theatre: 48
- Classroom: 30
- Boardroom: 28
- U-shape: 27
- Cabaret: 24
- Reception: 72
- Lunch/Dinner: 40
- Seated buffet: 30
- Standing buffet: 40

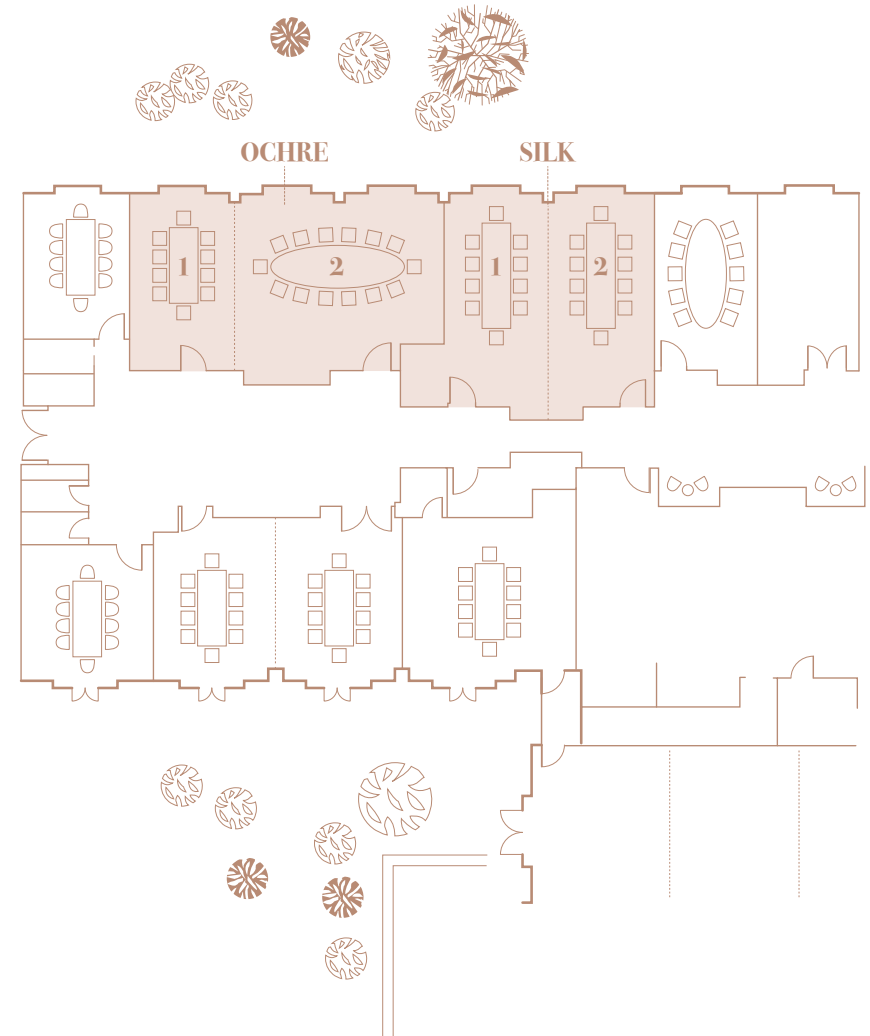

# ZEBRANO & ONYX



*When you need to host a small meeting or simply escape from the larger events of the day, our bright and airy syndicate rooms offer the perfect venue for some focussed meeting time.*

## KEY FEATURES

- Purpose Built
- Natural daylight
- Ground floor
- Air conditioning
- In-room dimmer controls
- Tungsten Halogen lights
- Light reduction
- Wi-Fi with private SDSL connection up to 5mb and additional bandwidth available on request
- LED screen technology
- Dry wipe walls (Zebrano only)
- Fixed boardroom table
- Onyx Suite interconnects with the Amber reception desk and business office

## ZEBRANO DIMENSIONS

- Area: 19.44sqm
- Height: 2.9m to 3.4m
- Length: 5.4m
- Width: 3.6m

## SET-UPS

- Boardroom: 10
- Lunch/Dinner: 10

## ONYX DIMENSIONS

- Area: 22.26sqm
- Height: 2.9m
- Length: 6.53m
- Width: 3.41m

## SET-UPS

- Boardroom: 11

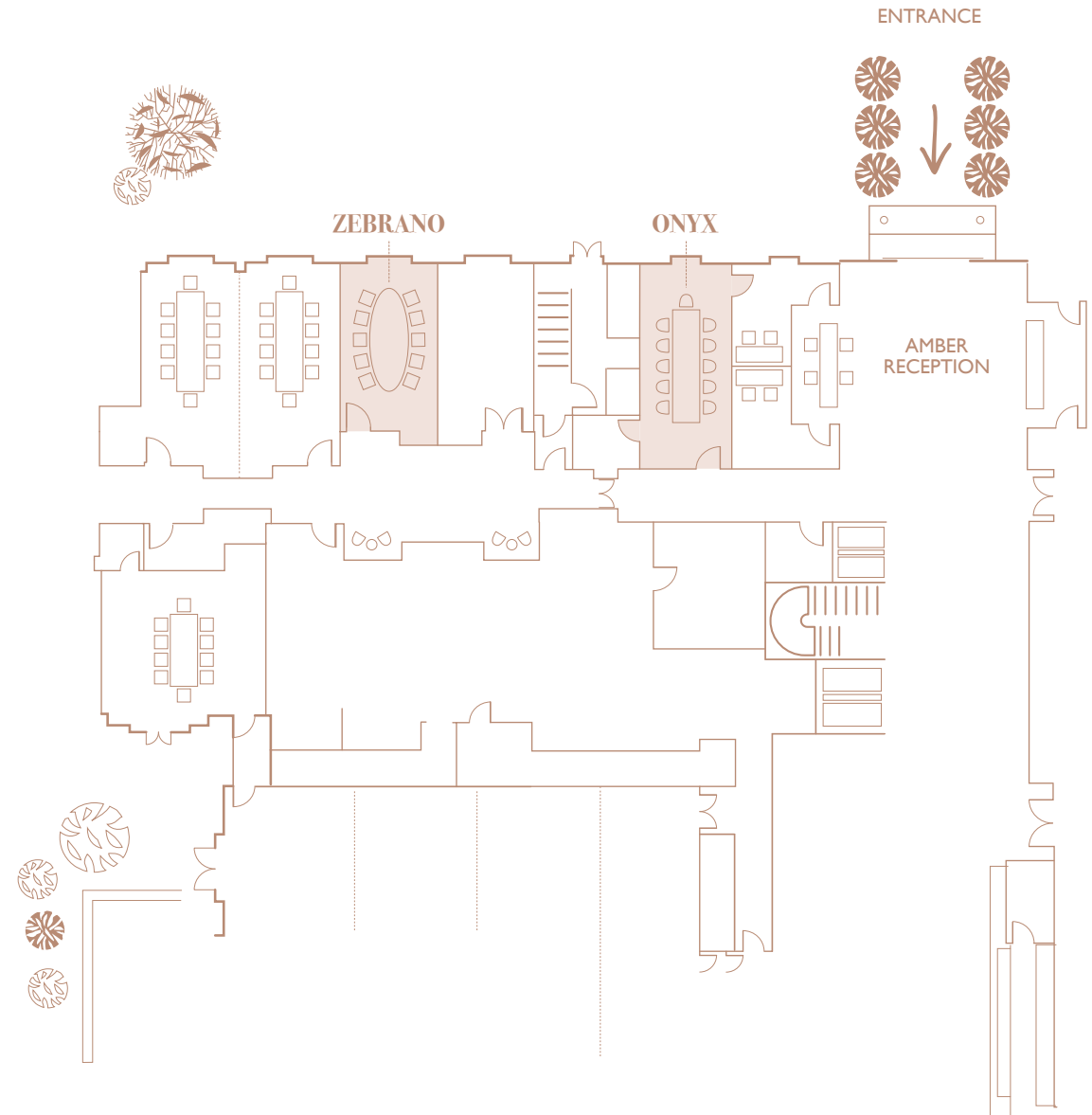

# IVORY



*Ivory is a little gem that makes a great choice for small to medium sized events. Flexible and designed with flair, it has its own private entrance with natural daylight and beautiful views, and extended social and break out spaces.*

## KEY FEATURES

- Purpose built
- Bespoke chandelier
- Natural Daylight
- Light reduction
- Ground floor
- Private entrance
- Own registration desk
- Divisible into 5 rooms
- LED screen technology in rooms 1, 2, 4 & 5 which can be linked
- Private reception area with in-built bar
- In-built PA system
- Air conditioning
- WiFi internet
- Linked room control
- In-room dimmer controls
- Tungsten Halogen lights
- Terrace overlooking the formal gardens

## DIMENSIONS

- Area: 132.24sqm
- Height: 2.9m to 3.4m
- Length: 23.2m
- Width: 5.7m

## SET-UPS

- Theatre: 120\*
- Classroom: 60\*
- Boardroom: 60
- U-shape: 64
- Cabaret: 64\*
- Reception: 150
- Lunch/Dinner: 120
- Dinner dance: 80
- Seated buffet: 80
- Standing buffet: 150
- Exhibition: 8 stands of 3x2m

\*front projection

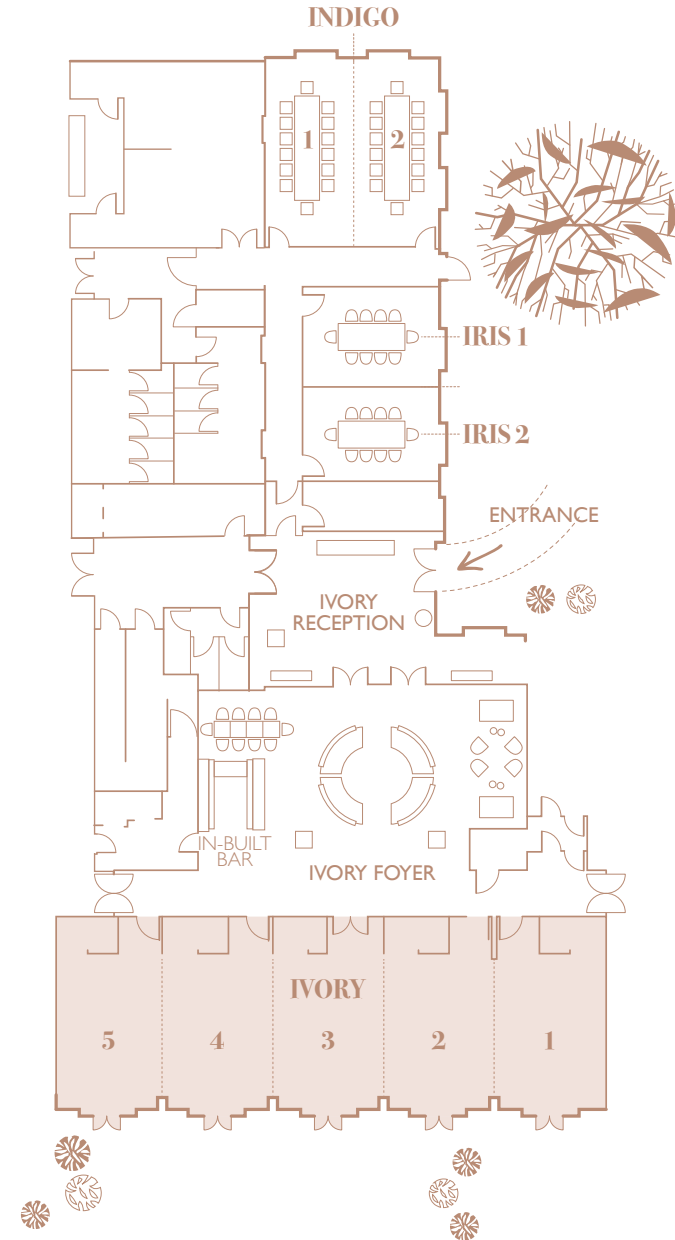

# INDIGO & IRIS



*Ideally located for the Ivory Suite, purpose built breakout spaces with white walls, natural daylight and in room technology.*

## KEY FEATURES

- Purpose built
- LED screen technology
- WIFI
- Natural daylight
- Ground floor
- Iris 1+2 has fixed boardroom tables
- Wall hanging flip charts
- Indigo can be split into two rooms

## INDIGO

### DIMENSIONS

- Area: 61.37sqm
- Height: 2.9m
- Length: 7.96m
- Width: 7.71m

### SET-UPS

- Theatre: 50
- Classroom: 24
- Boardroom: 18
- U-shape: 20
- Cabaret: 32
- Reception: 56
- Lunch/Dinner: 48
- Seated buffet: 40
- Standing buffet: 50

## IRIS

### DIMENSIONS

- Area: 20.93sqm
- Height: 2.9m
- Length: 5.26m
- Width: 3.98m

### SET-UPS

- Boardroom: 9

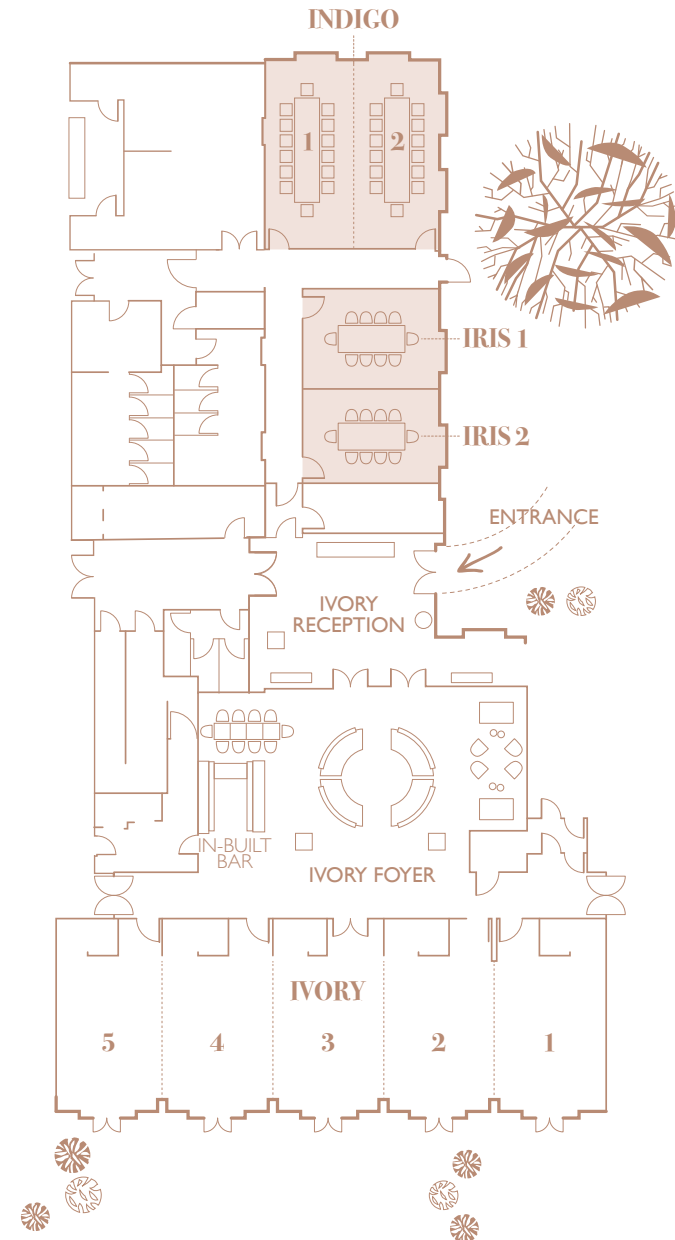



# CEDAR



*Our newest events space, a beautiful glass oval addition with its own private entrance. The Cedar is a great choice for meetings, events and celebrations. Totally flexible, with glass walls, natural daylight and beautiful views opening directly onto our Formal and Sunken Gardens.*

## KEY FEATURES

- Purpose built
- 85 inch LED screen technology
- Data projector and drop down screen
- WIFI
- Natural daylight
- Ground floor
- LED lighting and pin spotting
- 3 phase power
- Own private terrace
- Private reception area with in-built bar
- Dedicated entrance with registration desk

## DIMENSIONS

- Area: 205.4sqm
- Height: 3.33m
- Length: 15.74m
- Width: 13.05m

## SET-UPS

- Theatre: 166
- Classroom: 96
- Boardroom: 60
- U-shape: 48
- Cabaret: 84
- Reception: 200
- Lunch/Dinner: 168
- Dinner dance: 110
- Seated buffet: 100
- Standing buffet: 175
- Exhibition: 17 stands

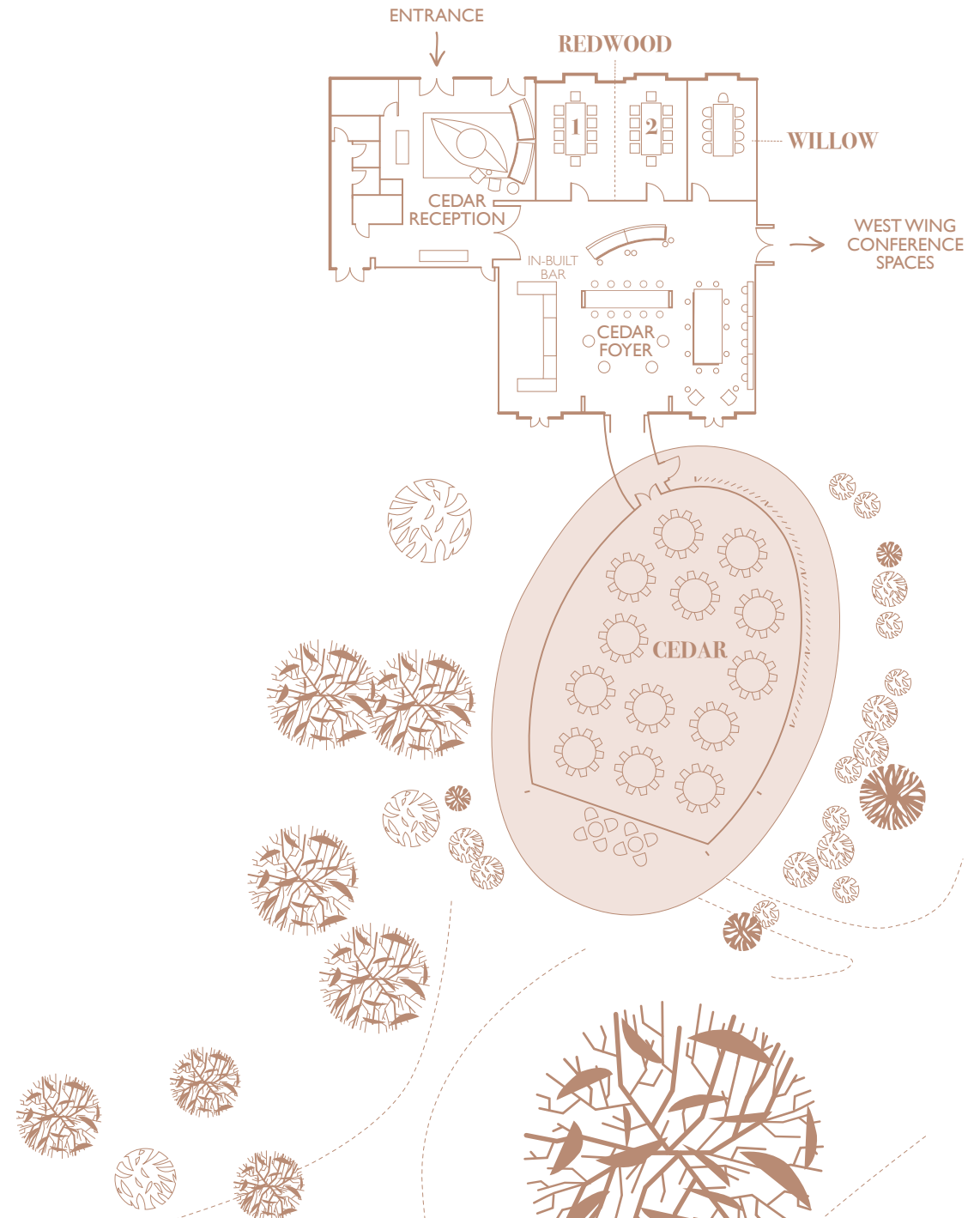

# REDWOOD & WILLOW



*Bright and contemporary rooms which are located off the Cedar Foyer, ideal for office and breakout space for The Cedar Suite.*

## KEY FEATURES

- Purpose built
- LED screen technology
- WIFI
- Natural daylight
- Ground floor
- Willow has fixed boardroom table and white board walls
- Wall hanging flip charts
- Redwood can be split into two

## REDWOOD DIMENSIONS

- Area: 43.63sqm
- Height: 2.9m
- Length: 5.66m
- Width: 7.71m

## SET-UPS

- Theatre: 40
- Classroom: 18
- Boardroom: 18
- U-shape: 18
- Cabaret: 18
- Reception: 40
- Lunch/Dinner: 24
- Seated buffet: 24
- Standing buffet: 40

## WILLOW DIMENSIONS

- Area: 22.1sqm
- Height: 2.9m
- Length: 6.28m
- Width: 3.52m

## SET-UPS

- Boardroom: 9

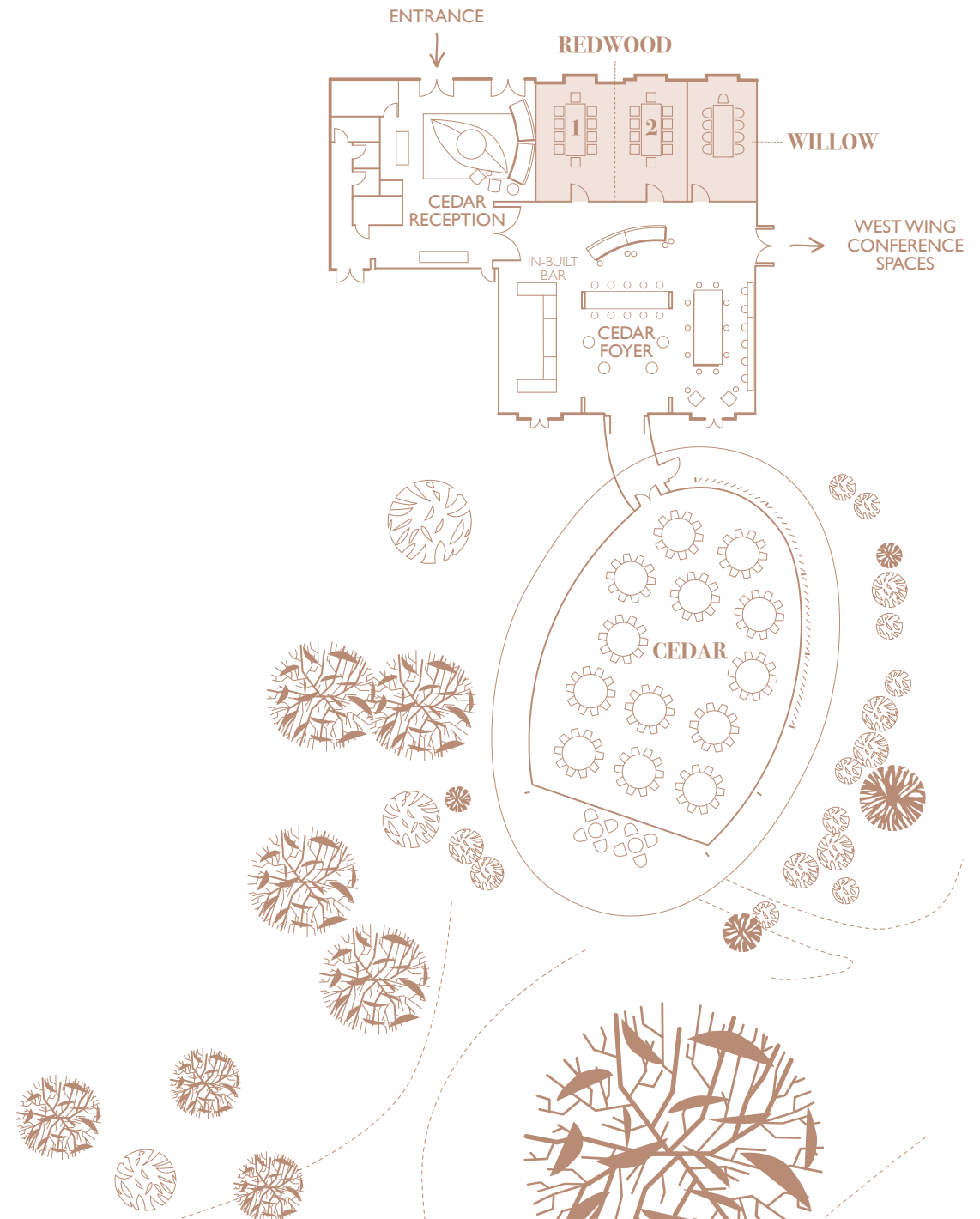

# THE MANSION



*Complete flexibility and endless possibilities. The Mansion and its Formal Gardens offer elegant, exclusive spaces for small to medium sized events.*

*The Donneraile, The Garden Room and Colette's, our exclusive dining room, all offer subtle and sophisticated decor with panoramic views across the grounds and gardens. Perfect for events or celebrations which demand a backdrop that is just a little bit special.*

## KEY FEATURES

- Grade II listed Mansion
- Ground floor
- Chandelier lighting
- Beautifully restored
- Access into private garden
- Natural daylight
- High ceiling and large windows
- WiFi
- Air conditioning
- Views over the golf course

## THE GARDEN ROOM

### DIMENSIONS

- Area: 51.6sqm
- Height: 4.30m
- Length: 8.6m
- Width: 6.5m

### SET-UPS

- Theatre: 16
- Boardroom: 14
- U-shape: 12
- Reception: 28
- Lunch/Dinner: 28
- Seated buffet: 20
- Standing buffet: 30

## DONNERAILE

### DIMENSIONS

- Area: 60.6sqm
- Height: 4.79m
- Length: 10.1m
- Width: 6.45m

### SET-UPS

- Boardroom: 24
- U-shape: 22
- Lunch/Dinner: 28
- Reception: 28

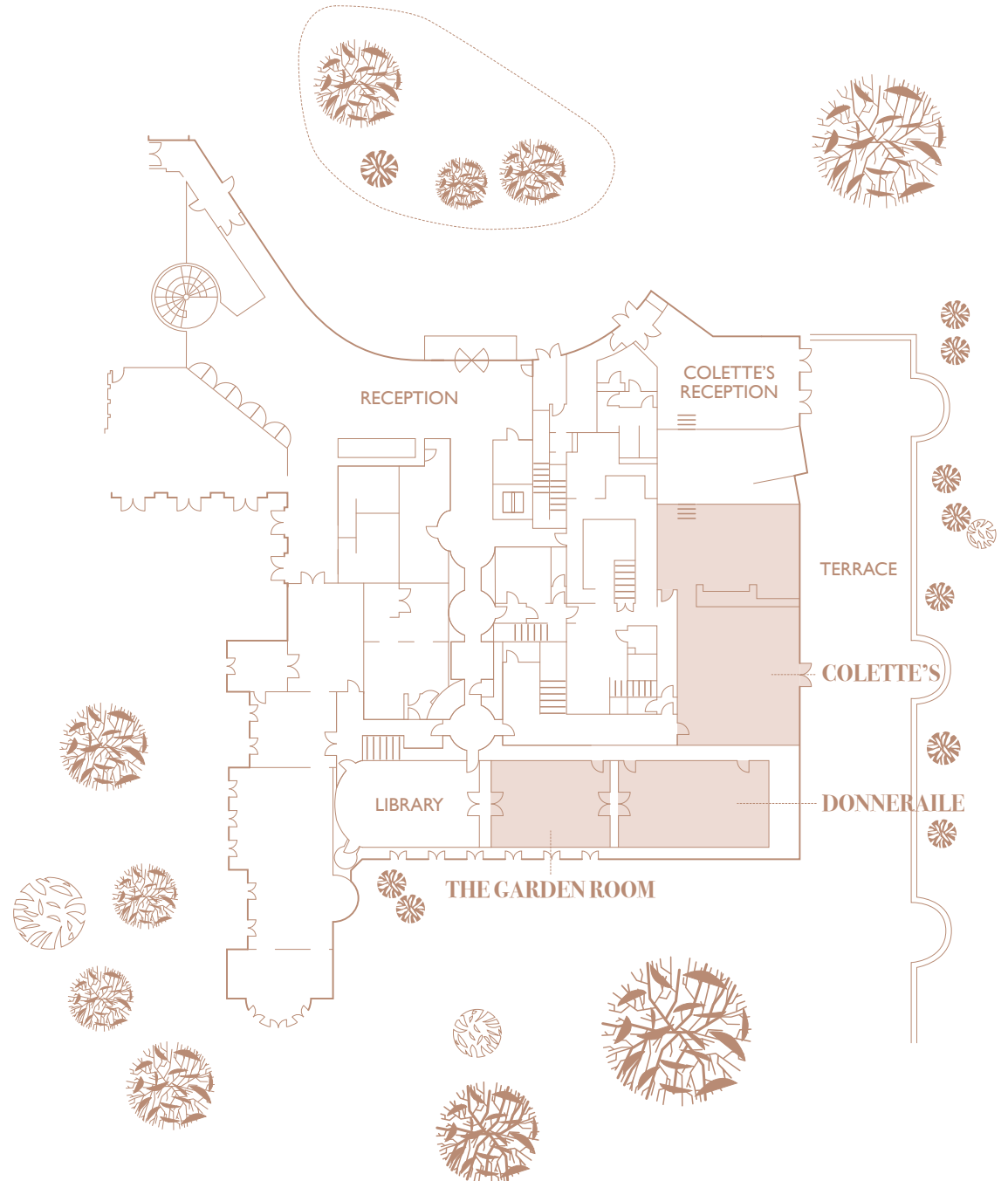

# THE WALLED GARDEN & THE POTTING SHED

*Complete flexibility and endless possibilities. The Potting Shed and the Walled Garden offer elegant, exclusive spaces for small to medium to large sized events.*

*This area is ideal for marquees and raj tents, the possibilities are endless.*

*Also to be discovered within the Walled Garden are our unique beach, tennis courts, outdoor pool, fruit trees, kitchen garden and even a giraffe.*

## DIMENSIONS THE WALLED GARDEN

- Area: 13,048sqm
- Length: 116.5m
- Width: 112m

## THE BEACH

- Area: 1,330sqm
- Length: 38m
- Width: 35m

## CROQUET LAWN

- Area: 684sqm
- Length: 18m
- Width: 38m

## TENNIS COURTS

- Area: 1,120sqm
- Length: 35m
- Width: 32m

## SWIMMING POOL

- Length: 25m
- Width: 10m

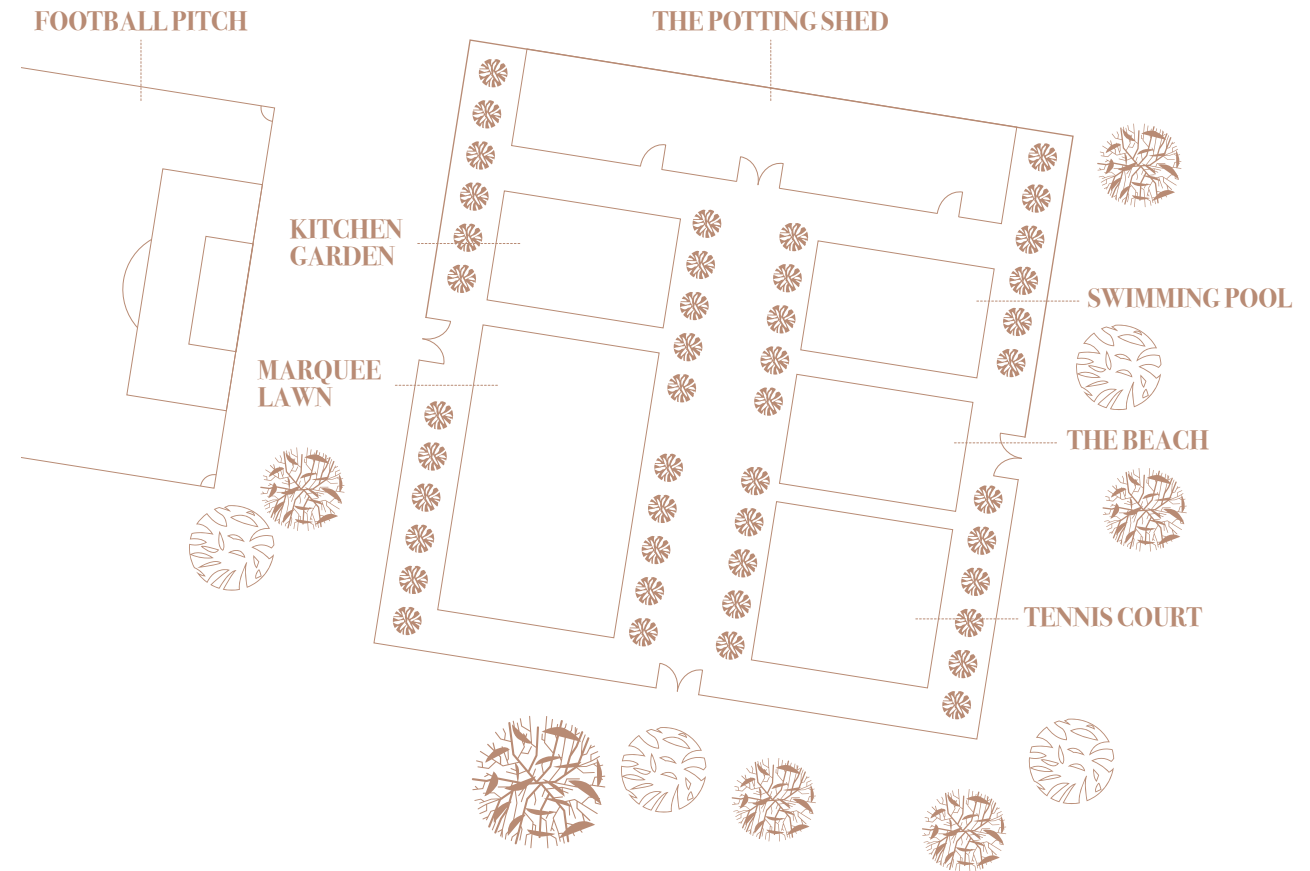

# THE POTTING SHED

*In our Walled Garden you'll find The Potting Shed. A beautifully restored Victorian glasshouse, the Potting Shed is the perfect mix of shabby chic and a wonderful space for a reception, summer cocktail party or evening barbecue. Its capacity can be increased with the addition of a marquee.*

## KEY FEATURES

- Natural daylight
- Ground floor
- Private entrance
- Glass ceiling
- Four interlinking rooms
- 3 phase power
- WiFi
- Air conditioning
- Overlooks the Walled Garden
- Outdoor space for marquee build

## DIMENSIONS

- Area: 247.5sqm
- Height: 1.7m to 3.4m
- Length: 55m
- Width: 4.5m

## SET-UPS

- Reception: 150
- Lunch/Dinner: 70
- Seated buffet: 60
- Standing buffet: 100
- Dinner Dance: 60

